

EF12.6 horizontal series transformer

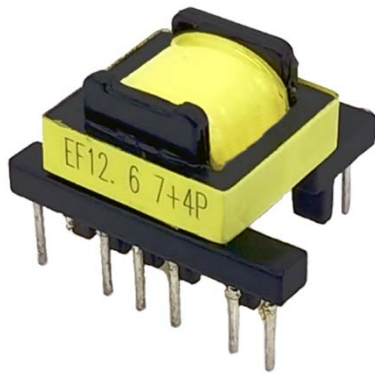

Features

- Through hole profile
- Forward or flyback topology
- Wide variety specifications
- SELV structure
- RoHS compatible
- Operating temperature: -20 to 125°C
- Wide application for power supplies and Led driver

Benefits

- Rapid prototyping available
- Custom design is available
- Aggressive price for EE structure

Mechanicals (in mm):

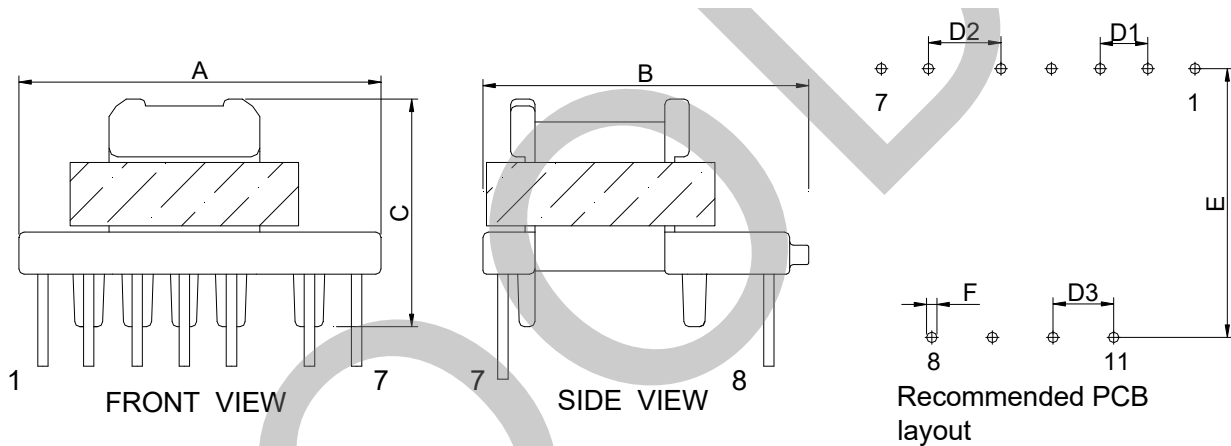

Series	A	B	C	D1	D2	D3	E	F
EF12.7	22.0Max.	20.5Max.	14.5Max.	2.72	4.50	3.50	15.35	Φ1.0



Huizhou Boody Technology Co., Ltd.
<http://www.boody.com.cn>

Tel: +86-752-2831031
Fax: +86-752-2831030
E-mail: sales@boody.com.cn

ISO9001/14001 Certified
UL insulation systems: E358019